

DOCUMENT NOTES:
Verify all dimensions on site before commencing work. Report all discrepancies to the Architect Prior to construction. Use figured dimensions in preference to scaled dimensions. Drawings made to larger scales and those showing particular parts of the works take precedence over drawings made to smaller scales or for general purposes. All work is to conform to relevant Australian Standards and Codes together with all Authorities' requirements and Regulations.

REV	DATE	DESCRIPTION	APP
A	06/10/20	ISSUED FOR DA - REVISED	AL

--- LOT BOUNDARY
--- PROPOSED DEVELOPMENT SITE

CONSULTANTS:



CLIENT:



ARCHITECT:

CM⁺

CONYBEARE MORRISON INTERNATIONAL P/L
ABN 50 055 972 248 | T | 61 2 8244 8888
W | www.cmplus.com.au | E | mail@cmplus.com.au
Darrel Conybeare NSW ARB No 2252 |
Bill Morrison NSW ARB No 2447



0 SCALE 1:500 20

SCALE: 1 : 500 @ A3

PROJECT:

19023
TIMBRELL PARK AMENITIES

HENLEY MARINE DR, FIVE DOCK
NSW 2046

DRAWING TITLE:
VISUAL IMPACT - CAMERA LOCATIONS
KEY PLAN

SHEET NUMBER:

DA9100

PLOTTED: 12/10/2020 12:01:46 PM

COPYRIGHT:

All rights reserved. This work is copyright and cannot be reproduced or copied by any means without the written permission of Conybeare Morrison International. Any license, express or implied, to use this document for any purpose whatsoever is restricted to the terms of the agreement between Conybeare Morrison International and the instructing party.

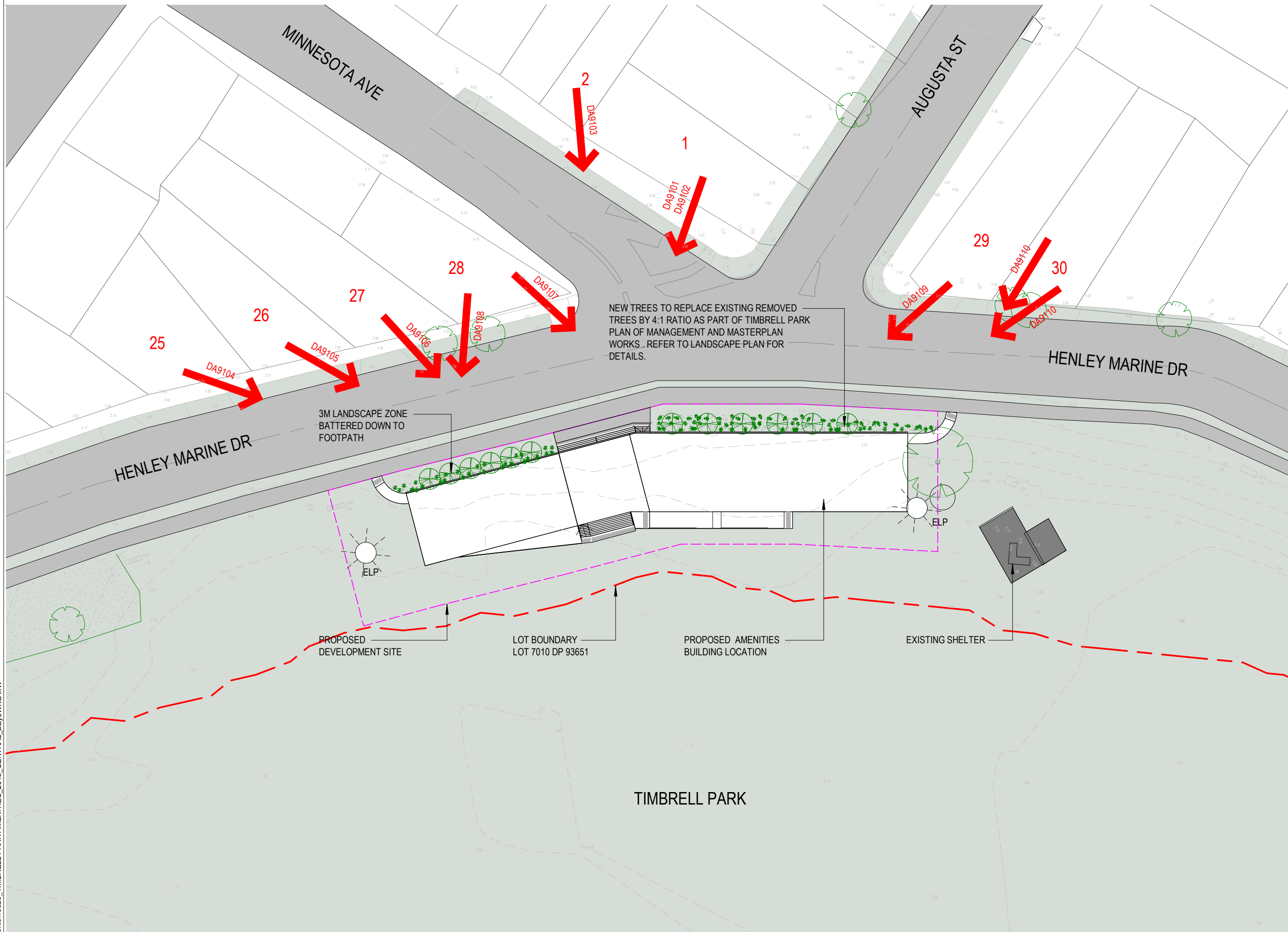

1 SITE PLAN - CAMERA LOCATIONS
1 : 500

NOT FOR CONSTRUCTION

C:\Users\alay\Documents\19023_TIMBRELL PARK AMENITIES_2018_CENTRAL_alay6WKGA.rvt



CAMERA: SONY DSC-HX300
LENS USED: 24MM
ADDRESS: 1 AUGUSTA ST (GROUND FLOOR)
CAMERA LOCATION : LIVING ROOM
POSITION OF PHOTOGRAPHER : STANDING (1.60-1.65M)

"PLEASE NOTE THAT THE CAMERA LOCATIONS AND RLS FROM THE NEIGHBOURS' PROPERTIES WERE NOT VERIFIED BY SURVEYORS. CM+ USED A METHOD OF INCORPORATING AVAILABLE SITE SURVEY INFORMATION AND KNOWN PHYSICAL ELEMENTS ON THE SITE INTO THE 3D MODEL FOR ACCURATE ALIGNMENT, BOTH IN PLAN AND IN VERTICAL ALIGNMENT. TO THE BEST OF OUR ABILITIES, THIS IMAGE GIVES A TRUE REPRESENTATION OF THE ACTUAL VIEW IMPACT THAT WOULD BE EVIDENT SHOULD THE DEVELOPMENT BE CONSTRUCTED IN ACCORDANCE WITH THIS DESIGN".

1 1 AUGUSTA ST-GROUND LEVEL
NTS

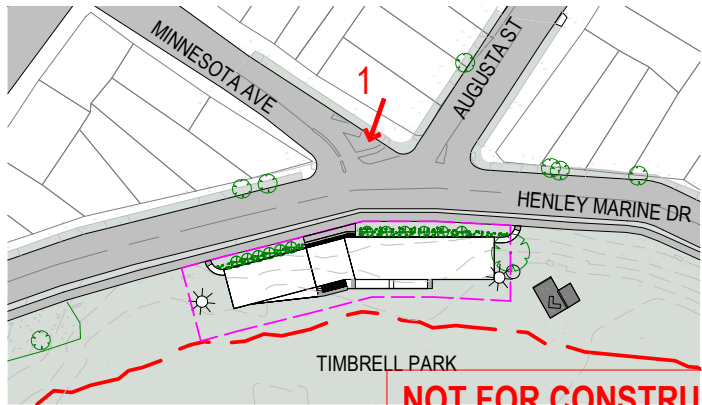

DOCUMENT NOTES:
Verify all dimensions on site before commencing work. Report all discrepancies to the Architect Prior to construction. Use figured dimensions in preference to scaled dimensions. Drawings made to larger scales and those showing particular parts of the works take precedence over drawings made to smaller scales or for general purposes. All work is to conform to relevant Australian Standards and Codes together with all Authorities' requirements and Regulations.

REV	DATE	DESCRIPTION	APP
A	05/08/20	ISSUED FOR INFORMATION	AL
B	11/08/20	ISSUED FOR INFORMATION	AL
C	06/10/20	ISSUED FOR DA - REVISED	AL

CONSULTANTS:



CLIENT:



ARCHITECT:

CM⁺

CONYBEARE MORRISON INTERNATIONAL P/L
ABN 50 055 972 248 | T | 61 2 8244 8888
W | www.cmplus.com.au | E | mail@cmplus.com.au
Darrel Conybeare NSW ARB No 2252 |
Bill Morrison NSW ARB No 2447

SCALE: As indicated @ A3

PROJECT:

19023
TIMBRELL PARK AMENITIES

HENLEY MARINE DR, FIVE DOCK
NSW 2046

DRAWING TITLE:
VISUAL IMPACT - 1 AUGUSTA
ST-GROUND LEVEL

SHEET NUMBER:

DA9101

PLOTTED: 12/10/2020 12:01:53 PM

COPYRIGHT:

All rights reserved. This work is copyright and cannot be reproduced or copied by any means without the written permission of Conybeare Morrison International. Any license, express or implied, to use this document for any purpose whatsoever is restricted to the terms of the agreement between Conybeare Morrison International and the instructing party.



CAMERA: SONY DSC-HX300
LENS USED: 24MM
ADDRESS: 1 AUGUSTA ST (UPPER FLOOR)
CAMERA LOCATION : BALCONY
POSITION OF PHOTOGRAPHER : STANDING (1.60-1.65M)

"PLEASE NOTE THAT THE CAMERA LOCATIONS AND RLS FROM THE NEIGHBOURS' PROPERTIES WERE NOT VERIFIED BY SURVEYORS. CM+ USED A METHOD OF INCORPORATING AVAILABLE SITE SURVEY INFORMATION AND KNOWN PHYSICAL ELEMENTS ON THE SITE INTO THE 3D MODEL FOR ACCURATE ALIGNMENT, BOTH IN PLAN AND IN VERTICAL ALIGNMENT. TO THE BEST OF OUR ABILITIES, THIS IMAGE GIVES A TRUE REPRESENTATION OF THE ACTUAL VIEW IMPACT THAT WOULD BE EVIDENT SHOULD THE DEVELOPMENT BE CONSTRUCTED IN ACCORDANCE WITH THIS DESIGN".

1 1 AUGUSTA ST-UPPER LEVEL
NTS

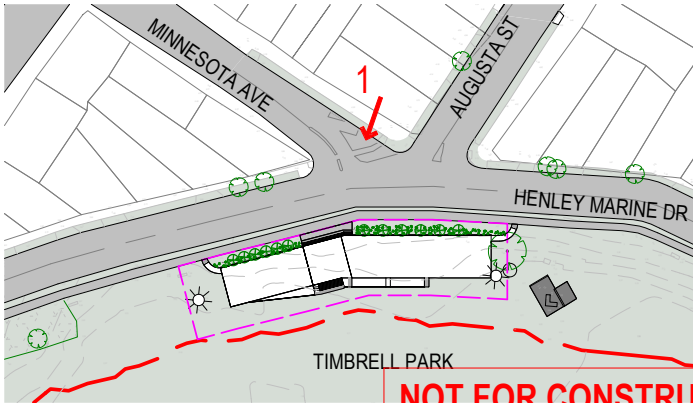

DOCUMENT NOTES:			
Verify all dimensions on site before commencing work. Report all discrepancies to the Architect Prior to construction. Use figured dimensions in preference to scaled dimensions. Drawings made to larger scales and those showing particular parts of the works take precedence over drawings made to smaller scales or for general purposes. All work is to conform to relevant Australian Standards and Codes together with all Authorities' requirements and Regulations.			
REV	DATE	DESCRIPTION	APP
A	05/08/20	ISSUED FOR INFORMATION	AL
B	11/08/20	ISSUED FOR INFORMATION	AL
C	06/10/20	ISSUED FOR DA - REVISED	AL

CONSULTANTS:



CLIENT:



ARCHITECT:



SCALE: As indicated @ A3

PROJECT:

19023

TIMBRELL PARK AMENITIES

HENLEY MARINE DR, FIVE DOCK
NSW 2046

DRAWING TITLE:
VISUAL IMPACT - 1 AUGUSTA
ST-UPPER LEVEL

SHEET NUMBER:

DA9102

PLOTTED: 12/10/2020 12:02:00 PM

COPYRIGHT:

All rights reserved. This work is copyright and cannot be reproduced or copied by any means without the written permission of Corybeare Morrison International. Any license, express or implied, to use this document for any purpose whatsoever is restricted to the terms of the agreement between Corybeare Morrison International and the instructing party.



CAMERA: SONY DSC-HX300
LENS USED: 24MM
ADDRESS: 2 MINNESOTA AVE
CAMERA LOCATION : FRONT PORCH
POSITION OF PHOTOGRAPHER : STANDING (1.60-1.65M)

1 2 MINNESOTA AVE
NTS

"PLEASE NOTE THAT THE CAMERA LOCATIONS AND RLS FROM THE NEIGHBOURS' PROPERTIES WERE NOT VERIFIED BY SURVEYORS. CM+ USED A METHOD OF INCORPORATING AVAILABLE SITE SURVEY INFORMATION AND KNOWN PHYSICAL ELEMENTS ON THE SITE INTO THE 3D MODEL FOR ACCURATE ALIGNMENT, BOTH IN PLAN AND IN VERTICAL ALIGNMENT. TO THE BEST OF OUR ABILITIES, THIS IMAGE GIVES A TRUE REPRESENTATION OF THE ACTUAL VIEW IMPACT THAT WOULD BE EVIDENT SHOULD THE DEVELOPMENT BE CONSTRUCTED IN ACCORDANCE WITH THIS DESIGN".

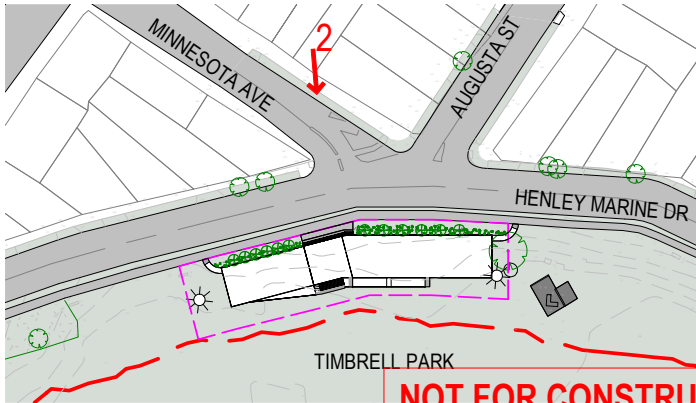

DOCUMENT NOTES:			
Verify all dimensions on site before commencing work. Report all discrepancies to the Architect Prior to construction. Use figured dimensions in preference to scaled dimensions. Drawings made to larger scales and those showing particular parts of the works take precedence over drawings made to smaller scales or for general purposes. All work is to conform to relevant Australian Standards and Codes together with all Authorities' requirements and Regulations.			
REV	DATE	DESCRIPTION	APP
A	05/08/20	ISSUED FOR INFORMATION	AL
B	11/08/20	ISSUED FOR INFORMATION	AL
C	06/10/20	ISSUED FOR DA - REVISED	AL

CONSULTANTS:



CLIENT:



ARCHITECT:



CONYBEARE MORRISON INTERNATIONAL P/L
ABN 50 055 972 248 | T | 61 2 8244 8888
W | www.cmplus.com.au | E | mail@cmplus.com.au
Darrel Conybeare NSW ARB No 2252 |
Bill Morrison NSW ARB No 2447

SCALE: As indicated @ A3

PROJECT:

19023
TIMBRELL PARK AMENITIES

HENLEY MARINE DR, FIVE DOCK
NSW 2046

DRAWING TITLE:
VISUAL IMPACT - 2 MINNESOTA AVE

SHEET NUMBER:

DA9103

PLOTTED: 12/10/2020 12:02:08 PM

COPYRIGHT:

All rights reserved. This work is copyright and cannot be reproduced or copied by any means without the written permission of Conybeare Morrison International. Any license, express or implied, to use this document for any purpose whatsoever is restricted to the terms of the agreement between Conybeare Morrison International and the instructing party.



CAMERA: SONY DSC-HX300
LENS USED: 24MM
ADDRESS: 25 HENLEY MARINE DRIVE
CAMERA LOCATION : BALCONY
POSITION OF PHOTOGRAPHER : STANDING (1.60-1.65M)

1 25 HENLEY MARINE DRIVE
NTS

"PLEASE NOTE THAT THE CAMERA LOCATIONS AND RLS FROM THE NEIGHBOURS' PROPERTIES WERE NOT VERIFIED BY SURVEYORS. CM+ USED A METHOD OF INCORPORATING AVAILABLE SITE SURVEY INFORMATION AND KNOWN PHYSICAL ELEMENTS ON THE SITE INTO THE 3D MODEL FOR ACCURATE ALIGNMENT, BOTH IN PLAN AND IN VERTICAL ALIGNMENT. TO THE BEST OF OUR ABILITIES, THIS IMAGE GIVES A TRUE REPRESENTATION OF THE ACTUAL VIEW IMPACT THAT WOULD BE EVIDENT SHOULD THE DEVELOPMENT BE CONSTRUCTED IN ACCORDANCE WITH THIS DESIGN".

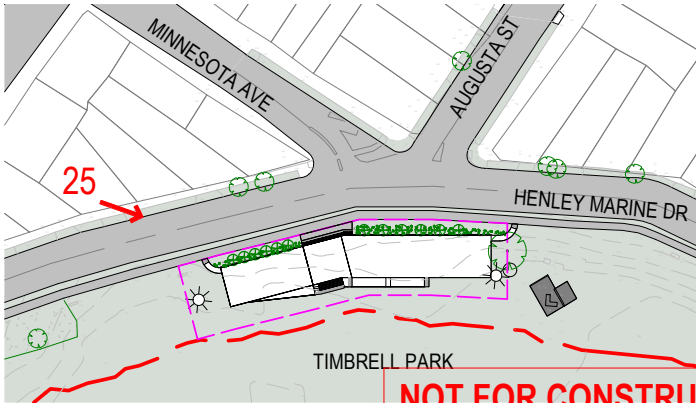

DOCUMENT NOTES:			
Verify all dimensions on site before commencing work. Report all discrepancies to the Architect Prior to construction. Use figured dimensions in preference to scaled dimensions. Drawings made to larger scales and those showing particular parts of the works take precedence over drawings made to smaller scales or for general purposes. All work is to conform to relevant Australian Standards and Codes together with all Authorities' requirements and Regulations.			
REV	DATE	DESCRIPTION	APP
A	05/08/20	ISSUED FOR INFORMATION	AL
B	11/08/20	ISSUED FOR INFORMATION	AL
C	06/10/20	ISSUED FOR DA - REVISED	AL

CONSULTANTS:



CLIENT:



ARCHITECT:

CM⁺

CONYBEARE MORRISON INTERNATIONAL P/L
ABN 50 055 972 248 | T | 61 2 8244 8888
W | www.cmplus.com.au | E | mail@cmplus.com.au
Darrel Conybeare NSW ARB No 2252 |
Bill Morrison NSW ARB No 2447

SCALE: As indicated @ A3

PROJECT:

19023
TIMBRELL PARK AMENITIES

HENLEY MARINE DR, FIVE DOCK
NSW 2046

DRAWING TITLE:
VISUAL IMPACT - 25 HENLEY MARINE
DRIVE

SHEET NUMBER:

DA9104

PLOTTED: 12/10/2020 12:02:13 PM

COPYRIGHT:

All rights reserved. This work is copyright and cannot be reproduced or copied by any means without the written permission of Conybeare Morrison International. Any license, express or implied, to use this document for any purpose whatsoever is restricted to the terms of the agreement between Conybeare Morrison International and the instructing party.



CAMERA: SONY DSC-HX300
LENS USED: 24MM
ADDRESS: 26 HENLEY MARINE DRIVE
CAMERA LOCATION : FRONT LAWN
POSITION OF PHOTOGRAPHER : STANDING (1.60-1.65M)

2 26 HENLEY MARINE DRIVE
NTS

"PLEASE NOTE THAT THE CAMERA LOCATIONS AND RLS FROM THE NEIGHBOURS' PROPERTIES WERE NOT VERIFIED BY SURVEYORS. CM+ USED A METHOD OF INCORPORATING AVAILABLE SITE SURVEY INFORMATION AND KNOWN PHYSICAL ELEMENTS ON THE SITE INTO THE 3D MODEL FOR ACCURATE ALIGNMENT, BOTH IN PLAN AND IN VERTICAL ALIGNMENT. TO THE BEST OF OUR ABILITIES, THIS IMAGE GIVES A TRUE REPRESENTATION OF THE ACTUAL VIEW IMPACT THAT WOULD BE EVIDENT SHOULD THE DEVELOPMENT BE CONSTRUCTED IN ACCORDANCE WITH THIS DESIGN".

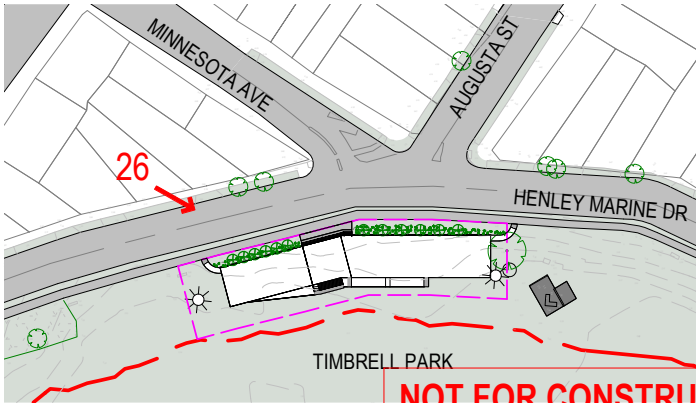

DOCUMENT NOTES:			
Verify all dimensions on site before commencing work. Report all discrepancies to the Architect Prior to construction. Use figured dimensions in preference to scaled dimensions. Drawings made to larger scales and those showing particular parts of the works take precedence over drawings made to smaller scales or for general purposes. All work is to conform to relevant Australian Standards and Codes together with all Authorities' requirements and Regulations.			
REV	DATE	DESCRIPTION	APP
A	05/08/20	ISSUED FOR INFORMATION	AL
B	11/08/20	ISSUED FOR INFORMATION	AL
C	06/10/20	ISSUED FOR DA - REVISED	AL

CONSULTANTS:



CLIENT:



ARCHITECT:

CM⁺
CONYBEARE MORRISON INTERNATIONAL P/L
ABN 50 055 972 248 | T | 61 2 8244 8888
W | www.cmplus.com.au | E | mail@cmplus.com.au
Darrel Conybeare NSW ARB No 2252 |
Bill Morrison NSW ARB No 2447

SCALE: As indicated @ A3

PROJECT:

19023
TIMBRELL PARK AMENITIES

HENLEY MARINE DR, FIVE DOCK
NSW 2046

DRAWING TITLE:
VISUAL IMPACT - 26 HENLEY MARINE
DRIVE

SHEET NUMBER:

DA9105

PLOTTED: 12/10/2020 12:02:20 PM

COPYRIGHT:

All rights reserved. This work is copyright and cannot be reproduced or copied by any means without the written permission of Conybeare Morrison International. Any license, express or implied, to use this document for any purpose whatsoever is restricted to the terms of the agreement between Conybeare Morrison International and the instructing party.



CAMERA: SONY DSC-HX300
LENS USED: 24MM
ADDRESS: 27 HENLEY MARINE DRIVE
CAMERA LOCATION : BALCONY
POSITION OF PHOTOGRAPHER : STANDING (1.60-1.65M)

"PLEASE NOTE THAT THE CAMERA LOCATIONS AND RLS FROM THE NEIGHBOURS' PROPERTIES WERE NOT VERIFIED BY SURVEYORS. CM+ USED A METHOD OF INCORPORATING AVAILABLE SITE SURVEY INFORMATION AND KNOWN PHYSICAL ELEMENTS ON THE SITE INTO THE 3D MODEL FOR ACCURATE ALIGNMENT, BOTH IN PLAN AND IN VERTICAL ALIGNMENT. TO THE BEST OF OUR ABILITIES, THIS IMAGE GIVES A TRUE REPRESENTATION OF THE ACTUAL VIEW IMPACT THAT WOULD BE EVIDENT SHOULD THE DEVELOPMENT BE CONSTRUCTED IN ACCORDANCE WITH THIS DESIGN".

1 27 HENLEY MARINE DRIVE
NTS

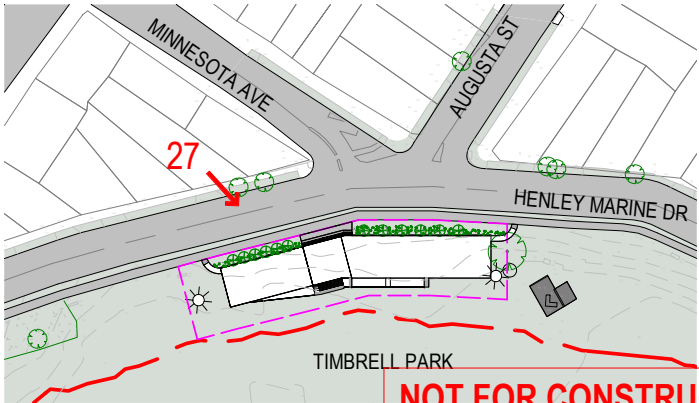

DOCUMENT NOTES:			
Verify all dimensions on site before commencing work. Report all discrepancies to the Architect Prior to construction. Use figured dimensions in preference to scaled dimensions. Drawings made to larger scales and those showing particular parts of the works take precedence over drawings made to smaller scales or for general purposes. All work is to conform to relevant Australian Standards and Codes together with all Authorities' requirements and Regulations.			
REV	DATE	DESCRIPTION	APP
A	05/08/20	ISSUED FOR INFORMATION	AL
B	11/08/20	ISSUED FOR INFORMATION	AL
C	06/10/20	ISSUED FOR DA - REVISED	AL

CONSULTANTS:



CLIENT:



ARCHITECT:

CM⁺

CONYBEARE MORRISON INTERNATIONAL P/L
ABN 50 055 972 248 | T | 61 2 8244 8888
W | www.cmplus.com.au | E | mail@cmplus.com.au
Darrel Conybeare NSW ARB No 2252 |
Bill Morrison NSW ARB No 2447

SCALE: As indicated @ A3

PROJECT:

19023
TIMBRELL PARK AMENITIES

HENLEY MARINE DR, FIVE DOCK
NSW 2046

DRAWING TITLE:
VISUAL IMPACT - 27 HENLEY MARINE
DRIVE

SHEET NUMBER:

DA9106

PLOTTED: 12/10/2020 12:02:27 PM

COPYRIGHT:

All rights reserved. This work is copyright and cannot be reproduced or copied by any means without the written permission of Conybeare Morrison International. Any license, express or implied, to use this document for any purpose whatsoever is restricted to the terms of the agreement between Conybeare Morrison International and the instructing party.



CAMERA: SONY DSC-HX300
LENS USED: 24MM
ADDRESS: 28 HENLEY MARINE DRIVE
CAMERA LOCATION : LIVING ROOM
POSITION OF PHOTOGRAPHER : STANDING (1.60-1.65M)

"PLEASE NOTE THAT THE CAMERA LOCATIONS AND RLS FROM THE NEIGHBOURS' PROPERTIES WERE NOT VERIFIED BY SURVEYORS. CM+ USED A METHOD OF INCORPORATING AVAILABLE SITE SURVEY INFORMATION AND KNOWN PHYSICAL ELEMENTS ON THE SITE INTO THE 3D MODEL FOR ACCURATE ALIGNMENT, BOTH IN PLAN AND IN VERTICAL ALIGNMENT. TO THE BEST OF OUR ABILITIES, THIS IMAGE GIVES A TRUE REPRESENTATION OF THE ACTUAL VIEW IMPACT THAT WOULD BE EVIDENT SHOULD THE DEVELOPMENT BE CONSTRUCTED IN ACCORDANCE WITH THIS DESIGN".

1 28 HENLEY MARINE DRIVE-VIEW 1
NTS

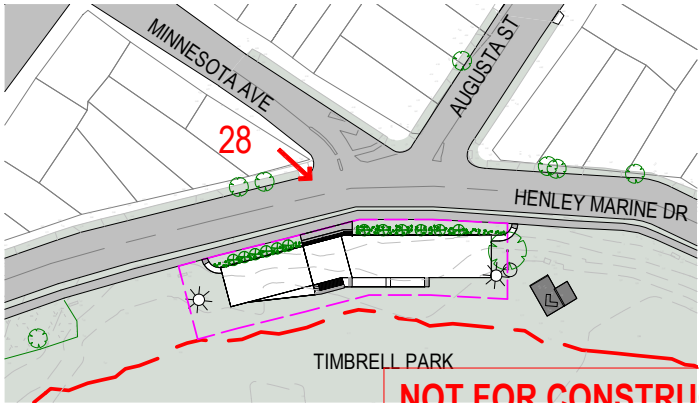

DOCUMENT NOTES:			
Verify all dimensions on site before commencing work. Report all discrepancies to the Architect Prior to construction. Use figured dimensions in preference to scaled dimensions. Drawings made to larger scales and those showing particular parts of the works take precedence over drawings made to smaller scales or for general purposes. All work is to conform to relevant Australian Standards and Codes together with all Authorities' requirements and Regulations.			
REV	DATE	DESCRIPTION	APP
A	05/08/20	ISSUED FOR INFORMATION	AL
B	11/08/20	ISSUED FOR INFORMATION	AL
C	06/10/20	ISSUED FOR DA - REVISED	AL

CONSULTANTS:



CLIENT:



ARCHITECT:

CM⁺

CONYBEARE MORRISON INTERNATIONAL P/L
ABN 50 055 972 248 | T | 61 2 8244 8888
W | www.cmplus.com.au | E | mail@cmplus.com.au
Darrel Conybeare NSW ARB No 2252 |
Bill Morrison NSW ARB No 2447

SCALE: As indicated @ A3

PROJECT:

19023
TIMBRELL PARK AMENITIES

HENLEY MARINE DR, FIVE DOCK
NSW 2046

DRAWING TITLE:
VISUAL IMPACT - 28 HENLEY MARINE
DRIVE-VIEW 1

SHEET NUMBER:

DA9107

REV:

C

PLOTTED: 12/10/2020 12:02:35 PM

COPYRIGHT:

All rights reserved. This work is copyright and cannot be reproduced or copied by any means without the written permission of Conybeare Morrison International. Any license, express or implied, to use this document for any purpose whatsoever is restricted to the terms of the agreement between Conybeare Morrison International and the instructing party.



CAMERA: SONY DSC-HX300
LENS USED: 24MM
ADDRESS: 28 HENLEY MARINE DRIVE
CAMERA LOCATION : LIVING ROOM
POSITION OF PHOTOGRAPHER : STANDING (1.60-1.65M)

"PLEASE NOTE THAT THE CAMERA LOCATIONS AND RLS FROM THE NEIGHBOURS' PROPERTIES WERE NOT VERIFIED BY SURVEYORS. CM+ USED A METHOD OF INCORPORATING AVAILABLE SITE SURVEY INFORMATION AND KNOWN PHYSICAL ELEMENTS ON THE SITE INTO THE 3D MODEL FOR ACCURATE ALIGNMENT, BOTH IN PLAN AND IN VERTICAL ALIGNMENT. TO THE BEST OF OUR ABILITIES, THIS IMAGE GIVES A TRUE REPRESENTATION OF THE ACTUAL VIEW IMPACT THAT WOULD BE EVIDENT SHOULD THE DEVELOPMENT BE CONSTRUCTED IN ACCORDANCE WITH THIS DESIGN".

1 28 HENLEY MARINE DRIVE-VIEW 2
NTS

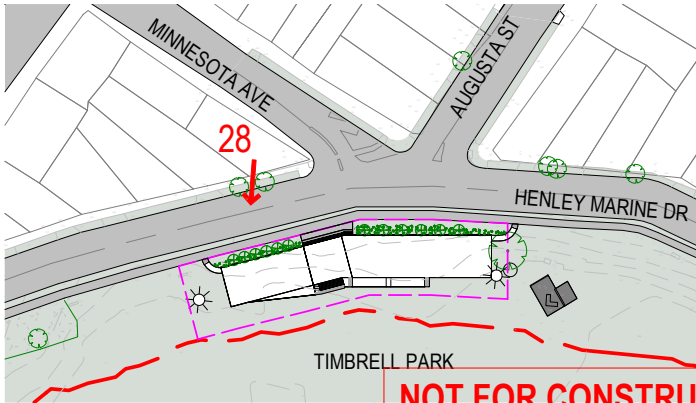

DOCUMENT NOTES:			
Verify all dimensions on site before commencing work. Report all discrepancies to the Architect Prior to construction. Use figured dimensions in preference to scaled dimensions. Drawings made to larger scales and those showing particular parts of the works take precedence over drawings made to smaller scales or for general purposes. All work is to conform to relevant Australian Standards and Codes together with all Authorities' requirements and Regulations.			
REV	DATE	DESCRIPTION	APP
A	05/08/20	ISSUED FOR INFORMATION	AL
B	11/08/20	ISSUED FOR INFORMATION	AL
C	06/10/20	ISSUED FOR DA - REVISED	AL

CONSULTANTS:



CLIENT:



ARCHITECT:



CONYBEARE MORRISON INTERNATIONAL P/L
ABN 50 055 972 248 | T | 61 2 8244 8888
W | www.cmplus.com.au | E | mail@cmplus.com.au
Darrel Conybeare NSW ARB No 2252 |
Bill Morrison NSW ARB No 2447

SCALE: As indicated @ A3

PROJECT:

19023
TIMBRELL PARK AMENITIES

HENLEY MARINE DR, FIVE DOCK
NSW 2046

DRAWING TITLE:
VISUAL IMPACT - 28 HENLEY MARINE
DRIVE-VIEW 2

SHEET NUMBER:

DA9108

PLOTTED: 12/10/2020 12:02:43 PM

COPYRIGHT:

All rights reserved. This work is copyright and cannot be reproduced or copied by any means without the written permission of Conybeare Morrison International. Any license, express or implied, to use this document for any purpose whatsoever is restricted to the terms of the agreement between Conybeare Morrison International and the instructing party.



CAMERA: SONY DSC-HX300
LENS USED: 24MM
ADDRESS: 29 HENLEY MARINE DRIVE
CAMERA LOCATION : FRONT PORCH
POSITION OF PHOTOGRAPHER : STANDING (1.60-1.65M)

"PLEASE NOTE THAT THE CAMERA LOCATIONS AND RLS FROM THE NEIGHBOURS' PROPERTIES WERE NOT VERIFIED BY SURVEYORS. CM+ USED A METHOD OF INCORPORATING AVAILABLE SITE SURVEY INFORMATION AND KNOWN PHYSICAL ELEMENTS ON THE SITE INTO THE 3D MODEL FOR ACCURATE ALIGNMENT, BOTH IN PLAN AND IN VERTICAL ALIGNMENT. TO THE BEST OF OUR ABILITIES, THIS IMAGE GIVES A TRUE REPRESENTATION OF THE ACTUAL VIEW IMPACT THAT WOULD BE EVIDENT SHOULD THE DEVELOPMENT BE CONSTRUCTED IN ACCORDANCE WITH THIS DESIGN".

1 29 HENLEY MARINE DRIVE
NTS

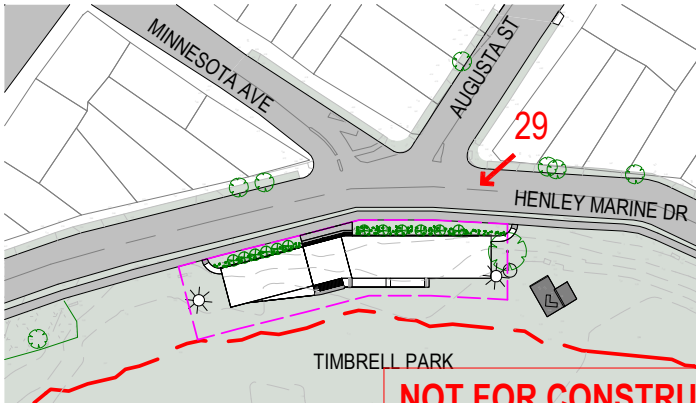

DOCUMENT NOTES:			
Verify all dimensions on site before commencing work. Report all discrepancies to the Architect Prior to construction. Use figured dimensions in preference to scaled dimensions. Drawings made to larger scales and those showing particular parts of the works take precedence over drawings made to smaller scales or for general purposes. All work is to conform to relevant Australian Standards and Codes together with all Authorities' requirements and Regulations.			
REV	DATE	DESCRIPTION	APP
A	05/08/20	ISSUED FOR INFORMATION	AL
B	11/08/20	ISSUED FOR INFORMATION	AL
C	06/10/20	ISSUED FOR DA - REVISED	AL

CONSULTANTS:



CLIENT:



ARCHITECT:

CM⁺

CONYBEARE MORRISON INTERNATIONAL P/L
ABN 50 055 972 248 | T | 61 2 8244 8888
W | www.cmplus.com.au | E | mail@cmplus.com.au
Darrel Conybeare NSW ARB No 2252 |
Bill Morrison NSW ARB No 2447

SCALE: As indicated @ A3

PROJECT:

19023
TIMBRELL PARK AMENITIES

HENLEY MARINE DR, FIVE DOCK
NSW 2046

DRAWING TITLE:
VISUAL IMPACT - 29 HENLEY MARINE
DRIVE

SHEET NUMBER:

DA9109

PLOTTED: 12/10/2020 12:02:50 PM

COPYRIGHT:

All rights reserved. This work is copyright and cannot be reproduced or copied by any means without the written permission of Conybeare Morrison International. Any license, express or implied, to use this document for any purpose whatsoever is restricted to the terms of the agreement between Conybeare Morrison International and the instructing party.



CAMERA: SONY DSC-HX300
LENS USED: 24MM
ADDRESS: 30 HENLEY MARINE DRIVE-VIEW 1
CAMERA LOCATION : BALCONY
POSITION OF PHOTOGRAPHER : STANDING (1.60-1.65M)

"PLEASE NOTE THAT THE CAMERA LOCATIONS AND RLS FROM THE NEIGHBOURS' PROPERTIES WERE NOT VERIFIED BY SURVEYORS. CM+ USED A METHOD OF INCORPORATING AVAILABLE SITE SURVEY INFORMATION AND KNOWN PHYSICAL ELEMENTS ON THE SITE INTO THE 3D MODEL FOR ACCURATE ALIGNMENT, BOTH IN PLAN AND IN VERTICAL ALIGNMENT. TO THE BEST OF OUR ABILITIES, THIS IMAGE GIVES A TRUE REPRESENTATION OF THE ACTUAL VIEW IMPACT THAT WOULD BE EVIDENT SHOULD THE DEVELOPMENT BE CONSTRUCTED IN ACCORDANCE WITH THIS DESIGN".

1 30 HENLEY MARINE DRIVE-VIEW 1
NTS

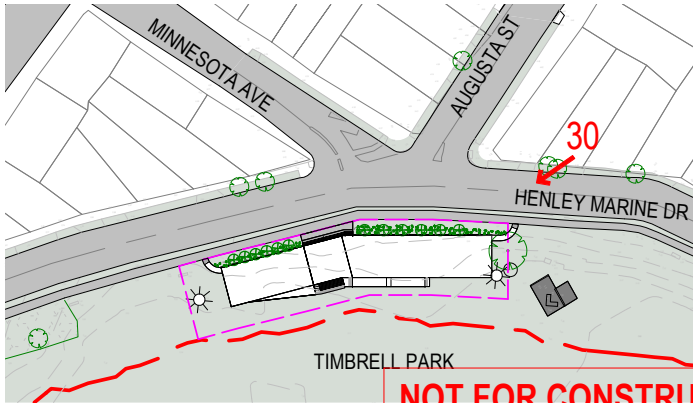

DOCUMENT NOTES:			
Verify all dimensions on site before commencing work. Report all discrepancies to the Architect Prior to construction. Use figured dimensions in preference to scaled dimensions. Drawings made to larger scales and those showing particular parts of the works take precedence over drawings made to smaller scales or for general purposes. All work is to conform to relevant Australian Standards and Codes together with all Authorities' requirements and Regulations.			
REV	DATE	DESCRIPTION	APP
A	05/08/20	ISSUED FOR INFORMATION	AL
B	11/08/20	ISSUED FOR INFORMATION	AL
C	06/10/20	ISSUED FOR DA - REVISED	AL

CONSULTANTS:



CLIENT:



ARCHITECT:



CONYBEARE MORRISON INTERNATIONAL P/L
ABN 50 055 972 248 | T | 61 2 8244 8888
W | www.cmplus.com.au | E | mail@cmplus.com.au
Darrel Conybeare NSW ARB No 2252 |
Bill Morrison NSW ARB No 2447

SCALE: As indicated @ A3

PROJECT:

19023
TIMBRELL PARK AMENITIES

HENLEY MARINE DR, FIVE DOCK
NSW 2046

DRAWING TITLE:
VISUAL IMPACT - 30 HENLEY MARINE
DRIVE-VIEW 1

SHEET NUMBER:

DA9110

PLOTTED: 12/10/2020 12:02:57 PM

COPYRIGHT:

All rights reserved. This work is copyright and cannot be reproduced or copied by any means without the written permission of Conybeare Morrison International. Any license, express or implied, to use this document for any purpose whatsoever is restricted to the terms of the agreement between Conybeare Morrison International and the instructing party.



CAMERA: SONY DSC-HX300
LENS USED: 24MM
ADDRESS: 30 HENLEY MARINE DRIVE-VIEW 2
CAMERA LOCATION : DRIVEWAY
POSITION OF PHOTOGRAPHER : STANDING (1.60-1.65M)

"PLEASE NOTE THAT THE CAMERA LOCATIONS AND RLS FROM THE NEIGHBOURS' PROPERTIES WERE NOT VERIFIED BY SURVEYORS. CM+ USED A METHOD OF INCORPORATING AVAILABLE SITE SURVEY INFORMATION AND KNOWN PHYSICAL ELEMENTS ON THE SITE INTO THE 3D MODEL FOR ACCURATE ALIGNMENT, BOTH IN PLAN AND IN VERTICAL ALIGNMENT. TO THE BEST OF OUR ABILITIES, THIS IMAGE GIVES A TRUE REPRESENTATION OF THE ACTUAL VIEW IMPACT THAT WOULD BE EVIDENT SHOULD THE DEVELOPMENT BE CONSTRUCTED IN ACCORDANCE WITH THIS DESIGN".

1 30 HENLEY MARINE DRIVE-VIEW 2
NTS

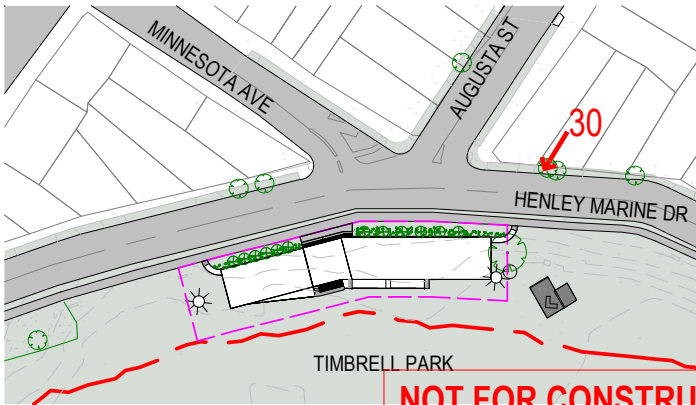

DOCUMENT NOTES:			
Verify all dimensions on site before commencing work. Report all discrepancies to the Architect Prior to construction. Use figured dimensions in preference to scaled dimensions. Drawings made to larger scales and those showing particular parts of the works take precedence over drawings made to smaller scales or for general purposes. All work is to conform to relevant Australian Standards and Codes together with all Authorities' requirements and Regulations.			
REV	DATE	DESCRIPTION	APP
A	05/08/20	ISSUED FOR INFORMATION	AL
B	11/08/20	ISSUED FOR INFORMATION	AL
C	06/10/20	ISSUED FOR DA - REVISED	AL

CONSULTANTS:



CLIENT:



ARCHITECT:



CONYBEARE MORRISON INTERNATIONAL P/L
ABN 50 055 972 248 | T | 61 2 8244 8888
W | www.cmplus.com.au | E | mail@cmplus.com.au
Darrel Conybeare NSW ARB No 2252 |
Bill Morrison NSW ARB No 2447

SCALE: As indicated @ A3

PROJECT:

19023
TIMBRELL PARK AMENITIES

HENLEY MARINE DR, FIVE DOCK
NSW 2046

DRAWING TITLE:
VISUAL IMPACT - 30 HENLEY MARINE
DRIVE-VIEW 2

SHEET NUMBER:

DA9111

REV:

C

PLOTTED: 12/10/2020 12:03:05 PM

COPYRIGHT:

All rights reserved. This work is copyright and cannot be reproduced or copied by any means without the written permission of Conybeare Morrison International. Any license, express or implied, to use this document for any purpose whatsoever is restricted to the terms of the agreement between Conybeare Morrison International and the instructing party.